

by Guttercrest

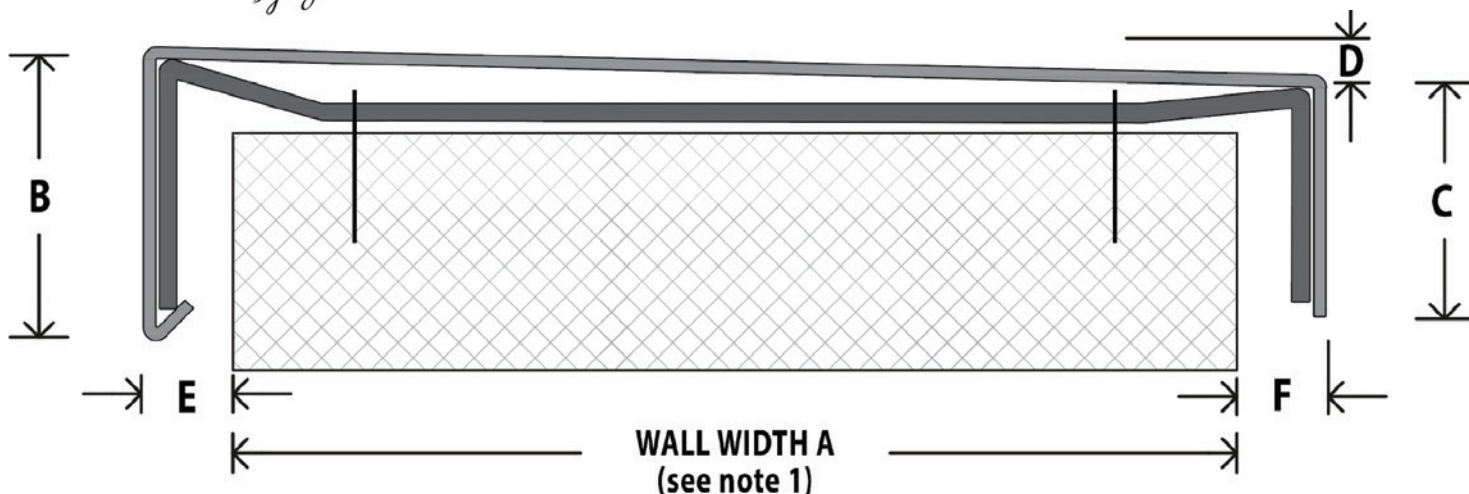

COMPANY: _____ PROJECT REFERENCE: _____

PROJECT NAME: _____

EMAIL: _____ TEL: _____

A - WALL WIDTH:

	(See note 1)
--	--------------

B - FRONT COPING HEIGHT:

	65mm minimum RECOMMENDED
--	-----------------------------

C - BACK COPING HEIGHT:

	55mm minimum RECOMMENDED
--	-----------------------------

D - FALL FRONT TO BACK:

	10mm fall minimum 20mm on walls over 550mm wide
--	--

E - FRONT WALL TO COPING OVERHANG:

	35mm minimum RECOMMENDED
--	-----------------------------

F - REAR WALL TO COPING OVERHANG:

	35mm minimum RECOMMENDED
--	-----------------------------

G - PAINT COLOUR OR MILL FINISH:

	(RAL or BS colour reference)
--	---------------------------------

- WARNING** WALLS SHOULD ONLY BE MEASURED AFTER ALL SITE FINISHES HAVE BEEN APPLIED, i. e. RENDERING/CLADDING ETC. AND AT REGULAR INTERVALS TO ENSURE CORRECT SIZING.
- COPING SYSTEM IS SUPPLIED WITH STANDARD BRACKETS, WITH 2 X FIXING HOLES. VERY WIDE COPINGS SHOULD HAVE ADDITIONAL CENTRE FIXINGS.
- DIMENSIONS SUGGESTED ARE STANDARD. NON STANDARD CONFIGURATIONS CAN BE MANUFACTURED TO CUSTOMER REQUIREMENTS & CONSIDERATION SHOULD BE GIVEN TO NHBC ETC.

IT IS THE END USER'S RESPONSIBILITY TO ENSURE FIXINGS AND FIXING BACKGROUNDS ARE SUITABLE AND FIT FOR PURPOSE.

SIGNATURE: _____ NAME: _____ DATE: _____